



Submitted to
Southern Indiana
Gas & Electric Company
(SIGECO)
211 NW Riverside Drive
Evansville, IN 47708

Submitted by
AECOM
13640 Briarwick Drive
Austin, Texas 78729
October 11, 2024

CCR Annual Inspection §257.83 (b)

for the

East Ash Pond

at the

F. B. Culley Generating Station

Revision 0

Table of Contents

Executive Summary..... 1

1 Introduction..... 1-1

 1.1 Purpose of this Report 1-1

 1.2 Brief Description of Impoundment..... 1-1

2 Annual Inspection Description..... 2-1

 2.1 Annual Inspection 2-1

 2.1.1 Review of Available Information 2-1

 2.1.2 Visual Inspection 2-1

 2.2 Content of the Inspection Report 2-2

 2.3 Frequency of Inspections 2-3

 2.4 Deficiency Identified..... 2-3

 2.4.1 Previous Inspection 2-3

 2.4.2 Current Inspection 2-4

3 Certification..... 3-1

4 Limitations..... 4-1

Tables

- Table ES-1 Summary**
- Table 1-1 CCR Rule Cross Reference Table**

Appendices

- Appendix A Figures**
- Figure 1 – Location Map
- Figure 2 – Site Map
- Figure 3 – Inspection Site Plan

Executive Summary

This Coal Combustion Residuals (CCR) Annual Inspection for the East Ash Pond at the Southern Indiana Gas & Electric Company (SIGECO), F. B. Culley Generating Station has been prepared in accordance with the requirements specified in the USEPA CCR Rule under 40 Code of Federal Regulations §257.83 (b). These regulations require that the specified documentation and assessments for an existing CCR surface impoundment be prepared within one year of the placement of the previous inspection report within the facility's operating record. The 2023 inspection report was placed in the Operating Record on October 13, 2023. SIGECO is placing this year's report in the facility's Operating Record no later than October 13, 2024, which is within one year of the date the previous year's inspection report was placed within the facility's Operating Record.

This Inspection for the East Ash Pond meets the regulatory requirements as summarized in **Table ES-1**.

Table ES-1 – Summary				
Report Section	CCR Rule Reference	Requirement Summary	Requirement Met?	Comments
2.1	§257.83 (b)(1)	<i>Annual Inspection</i>	Yes	The CCR Unit has met the annual inspection requirements
2.2	§257.83 (b)(2)	<i>Inspection Report</i>	Yes	The CCR Unit has met the inspection report requirements
2.3	§257.83 (b)(4)	<i>Frequency of Inspections</i>	Yes	The CCR Unit has met the required frequency of inspections
2.4	§257.83 (b)(5)	<i>No Deficiency Identified</i>	Yes	No deficiency identified

The Culley East Ash Pond has ceased receiving waste and is currently undergoing closure activities; however, it is considered an active surface impoundment until the completion of closure activities as defined within §257.53. All inspection requirements were evaluated and the surface impoundment was found to meet all requirements as required within each individual assessment in §257.83 (b).

1 Introduction

1.1 Purpose of this Report

The purpose of the Annual Inspection presented in this report is to document that the requirements specified in 40 Code of Federal Regulations (CFR) §257.83 (b) have been met to support the requirement under each of the applicable regulatory provisions for the F. B. Culley Generating Station (Culley) East Ash Pond. The Culley East Ash Pond is an existing coal combustion residual (CCR) surface impoundment as defined by 40 CFR §257.53. As previously noted, the CCR Rule requires that the specified documentation and assessments for an existing CCR surface impoundment be prepared within one year of the placement of the previous inspection report within the facility's operating record. The 2023 inspection report was placed into the facility's Operating Record on October 13, 2023. SIGECO is placing this year's report in the facility's Operating Record no later than October 13, 2024, which is within one year of the date the previous year's inspection report was placed within the facility's Operating Record

The following table summarizes the documentation required within the CCR Rule and the sections that specifically respond to those requirements of this assessment.

Table 1-1 – CCR Rule Cross Reference Table		
Report Section	Title	CCR Rule Reference
2.1	Annual Inspection	§257.83 (b)(1)
2.2	Inspection Report	§257.83 (b)(2)
2.3	Frequency of Inspections	§257.83 (b)(4)
2.4	Deficiency Identified	§257.83 (b)(5)

1.2 Brief Description of Impoundment

The Culley Station is located in Warrick County, Indiana, southeast of Newburgh, Indiana, and is owned and operated by Southern Indiana Gas and Electric Company (SIGECO). The Culley Station is located along the north bank of the Ohio River and the west bank of the Little Pigeon Creek along the southeast portion of the site. Culley has two CCR surface impoundments, identified as the West Ash Pond and the East Ash Pond. The West Ash Pond was a former CCR surface impoundment that has already completed closure in accordance with requirements of the Closure Plan developed per 40 CFR 257.102(b) as well as a separate Indiana Department of Environmental Management (IDEM)-approved Closure Plan. The East Ash Pond is no longer receiving CCR materials and activities have commenced for its closure. The East Ash Pond is located directly east of the Station and is approximately 10 acres in size.

The East Ash Pond was commissioned in or around 1971. Earthen embankments were constructed along the south and east sides of the impoundment. Structural fill used for the original construction of the Culley Station in the 1950s borders the impoundment to the west side, and west end of the north side. The east embankment intersects

a natural hillside on the east end of the north side of the impoundment. The embankment is approximately 1,200 feet long, 30 feet high, and has 2.4 to 1 (horizontal to vertical) exterior side slopes covered with trees and other undergrowth vegetation. Interior side slopes varied from 2.5 to 1 (horizontal to vertical) to 2 to 1 (horizontal to vertical) for the upper and lower portion of the embankment, respectively. The embankment crest elevation varies from 392.67 feet¹ to 396.42 feet and has a crest width of approximately 15 feet. The surface area of the impoundment is approximately 9.8 acres.

A site Location Map showing the area surrounding the Station is included as **Figure 1 of Appendix A**. **Figure 2 in Appendix A** presents the Culley Site Map.

¹ Unless otherwise noted, all elevations in this report are in the NAVD88 datum.

2 Annual Inspection Description

Regulatory Citation: 40 CFR §257.83 Inspection requirements for CCR surface impoundments

The Annual Inspection for the East Ash Pond is described in this section. Information about operational and maintenance procedures was provided by Culley plant personnel. The Culley Station follows an established maintenance program that quickly identifies and resolves issues of concern.

2.1 Annual Inspection

Regulatory Citation: 40 CFR §257.83 (b) Annual inspections by a qualified professional engineer;

- *(1) If the existing or new CCR surface impoundment or any lateral expansion of the CCR surface impoundment is subject to the periodic structural stability assessment requirements under §257.73 (d) or §257.74 (d), the CCR unit must additionally be inspected on a periodic basis by a qualified professional engineer to ensure that the design, construction, operation, and maintenance of the CCR unit is consistent with recognized and generally accepted good engineering standards.*

The East Ash Pond is subject to the periodic structural stability assessment requirements as mentioned. Thus, the following items were performed to comply with the CCR Rule.

2.1.1 Review of Available Information

Regulatory Citation: 40 CFR §257.83 (b)(1);

- *(i) A review of available information regarding the status and condition of the CCR unit, including, but not limited to, files available in the operating record (e.g., CCR unit design and construction information required by §257.73 (c)(1) and §257.74 (c)(1), previous periodic structural stability assessments required under §257.73 (d) and §257.74 (d), the results of inspections by a qualified person, and results of previous annual inspections).*

The available information was reviewed for the East Ash Pond, including the weekly inspection reports for inspections performed by plant personnel and the previous CCR Rule annual inspection performed by AECOM on September 19, 2023.

2.1.2 Visual Inspection

Regulatory Citation: 40 CFR §257.83 (b)(1);

- *(ii) A visual inspection of the CCR unit to identify signs of distress or malfunction of the CCR unit and appurtenant structures.*

The East Ash Pond was visually inspected by AECOM on September 17, 2024. No major signs of distress or malfunction of the CCR unit and appurtenant structures were identified, as also noted in Section 2.4.2.

Regulatory Citation: 40 CFR §257.83 (b)(1);

- *(iii) A visual inspection of any hydraulic structures underlying the base of the CCR unit or passing through the dike of the CCR unit for structural integrity and continued safe and reliable operation.*

There are no active hydraulic structures underlying the base or passing through the dike of the CCR unit of the East Ash Pond. A riser spillway was present in the southeast portion of the East Ash Pond which had discharged to Little Pigeon Creek but was previously plugged with concrete and abandoned. There was no seepage observed on the outer slope of the embankment in the area opposite the previous spillway. Therefore, no signs of structural deficiencies were identified during the visual inspection on September 17, 2024.

2.2 Content of the Inspection Report

Regulatory Citation: 40 CFR §257.83 (b)(2) Inspection report. The qualified professional engineer must prepare a report following each inspection that addresses the following:

- *(i) Any changes in geometry of the impounding structure since the previous annual inspection.*

No changes were observed.

- *(ii) The location and type of existing instrumentation and the maximum recorded readings of each instrument since the previous annual inspection.*

Plant personnel formerly obtained water surface elevation data for the East Ash Pond using an ultrasonic level indicator. As of September 2023, all impounded water has been removed from the East Ash Pond.

- *(iii) The approximate minimum, maximum, and present depth and elevation of the impounded water and CCR since the previous annual inspection.*

As of September 2023, all impounded water has been removed from the East Ash Pond.

CCR depths range from 0 feet to approximately 60 feet. The minimum CCR depth occurs along the perimeter of the impoundment. The maximum CCR depth occurs at the center of the splitter dike within the impoundment.

- *(iv) The storage capacity of the impounding structure at the time of the inspection.*

The storage capacity of the impounding structure is approximately 543,000 CY.

- *(v) The approximate volume of the impounded water and CCR at the time of the inspection.*

At the time of the inspection, all impounded water has been removed from the East Ash Pond. Prior to the commencement of CCR excavation for closure by removal, the approximate volume of CCR material within the East Ash Pond was 350,000 CY. As of September 30, 2024, approximately 124,000 CY of CCR material has been removed from the pond, with an estimated 226,000 CY remaining. The closure by removal process is ongoing.

- *(vi) Any appearances of an actual or potential structural weakness of the CCR unit, in addition to any existing conditions that are disrupting or have the potential to disrupt the operation and safety of the CCR unit and appurtenant structures.*

The visual inspection performed on September 17, 2024, did not reveal any actual or potential structural weaknesses.

- *(vii) Any other change(s) which may have affected the stability or operation of the impounding structure since the previous annual inspection.*

There were no changes which might have affected the stability or operation of the impounding structure since the previous annual inspection.

2.3 Frequency of Inspections

Regulatory Citation: 40 CFR §257.83 (b)(4);

- *(i) Except as provided for in paragraph (b)(4)(ii) of this section, the owner or operator of the CCR unit must conduct the inspection required by paragraphs (b)(1) and (2) of this section on an annual basis. The date of completing the initial inspection report is the basis for establishing the deadline to complete the first subsequent inspection. Any required inspection may be conducted prior to the required deadline provided the owner or operator places the completed inspection report into the facility's operating record within a reasonable amount of time. In all cases, the deadline for completing subsequent inspection reports is based on the date of completing the previous inspection report. For purposes of this section, the owner or operator has completed an inspection when the inspection report has been placed in the facility's operating record as required by §257.105 (g)(6).*

The prior (2023) annual inspection report was placed in the operating record on October 13, 2023. SIGECO will be placing this inspection report in the facility's operating record no later than October 13, 2024.

- *(ii) In any calendar year in which both the periodic inspection by a qualified professional engineer and the quinquennial (occurring every five years) structural stability assessment by a qualified professional engineer required by §257.73 (d) and §257.74 (d) are required to be completed, the annual inspection is not required, provided the structural stability assessment is completed during the calendar year. If the annual inspection is not conducted in a year as provided by this paragraph (b)(4)(ii), the deadline for completing the next annual inspection is one year from the date of completing the quinquennial structural stability assessment.*

The quinquennial structural stability assessment is not required for this year as it was completed in October 2021. Thus, an annual inspection report was submitted to SIGECO as stipulated in §257.83 (b)(4)(i).

2.4 Deficiency Identified

Regulatory Citation: 40 CFR §257.83 (b)(5);

- *If a deficiency or release is identified during an inspection, the owner or operator must remedy the deficiency or release as soon as feasible and prepare documentation detailing the corrective measures taken.*

Areas of concern from previous inspections were reviewed and described below in Section 2.4.1. No areas of concern were noted during this year's annual inspection performed on September 17, 2024, as noted in Section 2.4.2

2.4.1 Previous Inspection

There were no areas of concern noted during the previous annual inspection performed on September 19, 2023.

2.4.2 Current Inspection

No areas of concern were noted during the annual inspection performed on September 17, 2024.

3 Certification

This Certification Statement documents that the annual inspection has been completed for the East Ash Pond at the F. B. Culley Generating Station and this inspection report meets the requirements specified in 40 CFR §257.83 (b). The East Ash Pond is an active CCR surface impoundment as defined by 40 CFR §257.53.

CCR Unit: Southern Indiana Gas & Electric Company; F. B. Culley Generating Station; East Ash Pond

I, Jay Mokotoff, being a Registered Professional Engineer in good standing in the State of Indiana, do hereby certify, to the best of my knowledge, information, and belief that the information contained in this certification has been prepared in accordance with the accepted practice of engineering. I certify, for the above referenced CCR Unit, that the annual inspection dated October 11, 2024, meets the requirements of 40 CFR §257.83 (b).

Jay D. Mokotoff
Printed Name

10-11-2024
Date

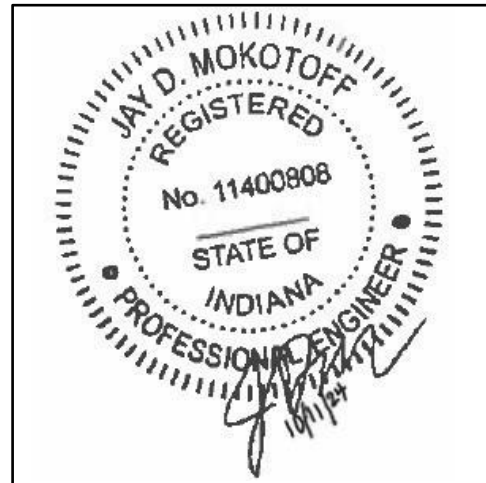

4 Limitations

Background information, design basis, and other data which AECOM has used in preparation of this report have been furnished to AECOM by SIGECO. AECOM has relied on this information as furnished and is not responsible for the accuracy of this information. Our recommendations are based on available information from previous and current investigations. These recommendations may be updated as future investigations are performed.

The conclusions presented in this report are intended only for the purpose, site location, and project indicated. The recommendations presented in this report should not be used for other projects or purposes. Conclusions or recommendations made from these data by others are their responsibility. The conclusions and recommendations are based on AECOM's understanding of current plant operations, maintenance, stormwater handling, and ash handling procedures at the Station, as provided by SIGECO. Changes in any of these operations or procedures may invalidate the findings in this report until AECOM has had the opportunity to review the findings and revise the report if necessary.

This development of the Annual Inspection was performed in accordance with the standard of care commonly used as state-of-practice in our profession. Specifically, our services have been performed in accordance with accepted principles and practices of the engineering profession. The conclusions presented in this report are professional opinions based on the indicated project criteria and data available at the time this report was prepared. Our services were provided in a manner consistent with the level of care and skill ordinarily exercised by other professional consultants under similar circumstances. No other representation is intended.

Appendix A Figures

Figure 1 – Location Map

Figure 2 – Site Map

Figure 3 – Inspection Site Plan

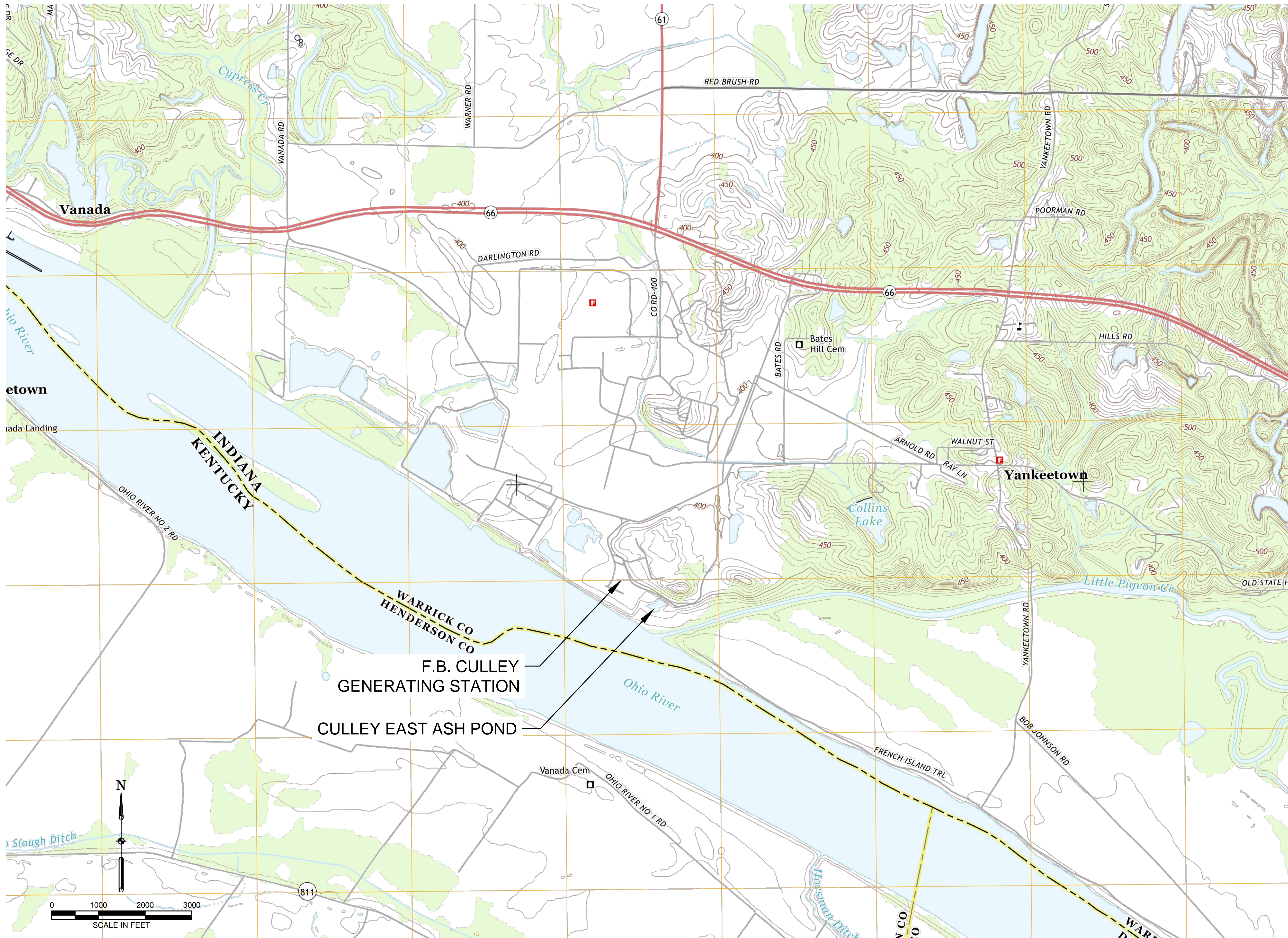

9400 Amberglen Boulevard
Austin, TX 78729-1100
512-454-4797 (phone)
512-454-8807 (fax)

**SOUTHERN INDIANA
GAS AND ELECTRIC
COMPANY**

One Vectren Square
Evansville, IN 47708
1-800-227-1376 (phone)

**F. B. CULLEY
GENERATING STATION
NEWBURGH, IN**

**CCR ANNUAL
INSPECTION**

**ISSUED FOR
CERTIFICATION**

ISSUED FOR BIDDING _____ DATE BY _____

ISSUED FOR CONSTRUCTION _____ DATE BY _____

REVISIONS

NO.	DESCRIPTION	DATE
△		
△		
△		
△		
△		

AECOM PROJECT NO:	60442676
DRAWN BY:	AG
DESIGNED BY:	AG
CHECKED BY:	JDM
DATE CREATED:	12/08/2017
PLOT DATE:	12/08/2017
SCALE:	1" = 1000'
ACAD VER:	2014

SHEET TITLE

LOCATION MAP

FIGURE 1



13640 Briarwick Dr.
Austin, TX 78729
512-454-4797 (phone)
512-454-8807 (fax)

**SOUTHERN INDIANA
GAS AND ELECTRIC
COMPANY
(SIGECO)**

One Vectren Square
Evansville, IN 47708
1-800-227-1376 (phone)

**F.B. CULLEY
GENERATING STATION
NEWBURGH, IN**

**CCR ANNUAL
INSPECTION
EAST ASH POND**

**ISSUED FOR
CERTIFICATION**

ISSUED FOR BIDDING _____ DATE BY _____

ISSUED FOR CONSTRUCTION _____ DATE BY _____

REVISIONS

NO.	DESCRIPTION	DATE
△		
△		
△		
△		
△		

AECOM PROJECT NO: 60586569

DRAWN BY: AG

DESIGNED BY: AG

CHECKED BY: JDM

DATE CREATED: 12/08/2017

PLOT DATE: 10/02/2024

SCALE: 1" = 150'

ACAD VER: 2018

SHEET TITLE

SITE MAP

FIGURE 2

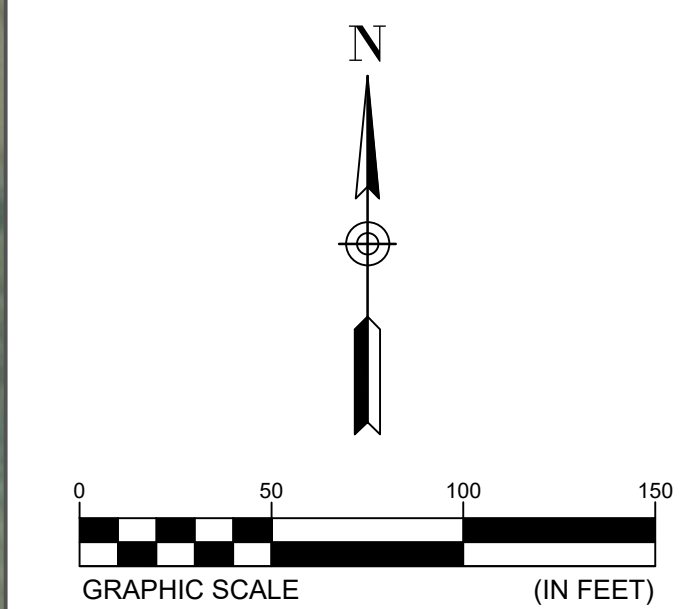



9400 Amberglen Boulevard
Austin, TX 78729-1100
512-454-4797 (phone)
512-454-8807 (fax)

**SOUTHERN INDIANA
GAS AND ELECTRIC
COMPANY**

One Vectren Square
Evansville, IN 47708
1-800-227-1376 (phone)

**F.B. CULLEY
GENERATING STATION
NEWBURGH, IN**

**CCR ANNUAL
INSPECTION
EAST ASH POND**

**ISSUED FOR
CERTIFICATION**

ISSUED FOR BIDDING _____ DATE BY _____

ISSUED FOR CONSTRUCTION _____ DATE BY _____

REVISIONS

NO.	DESCRIPTION	DATE
△		
△		
△		
△		
△		

AECOM PROJECT NO: 60586569

DRAWN BY: DMB

DESIGNED BY: DMB

CHECKED BY: JDM

DATE CREATED: 12/15/2020

PLOT DATE: 11/04/2022

SCALE: 1" = 50'

ACAD VER: 2018

SHEET TITLE

INSPECTION SITE PLAN

FIGURE 3

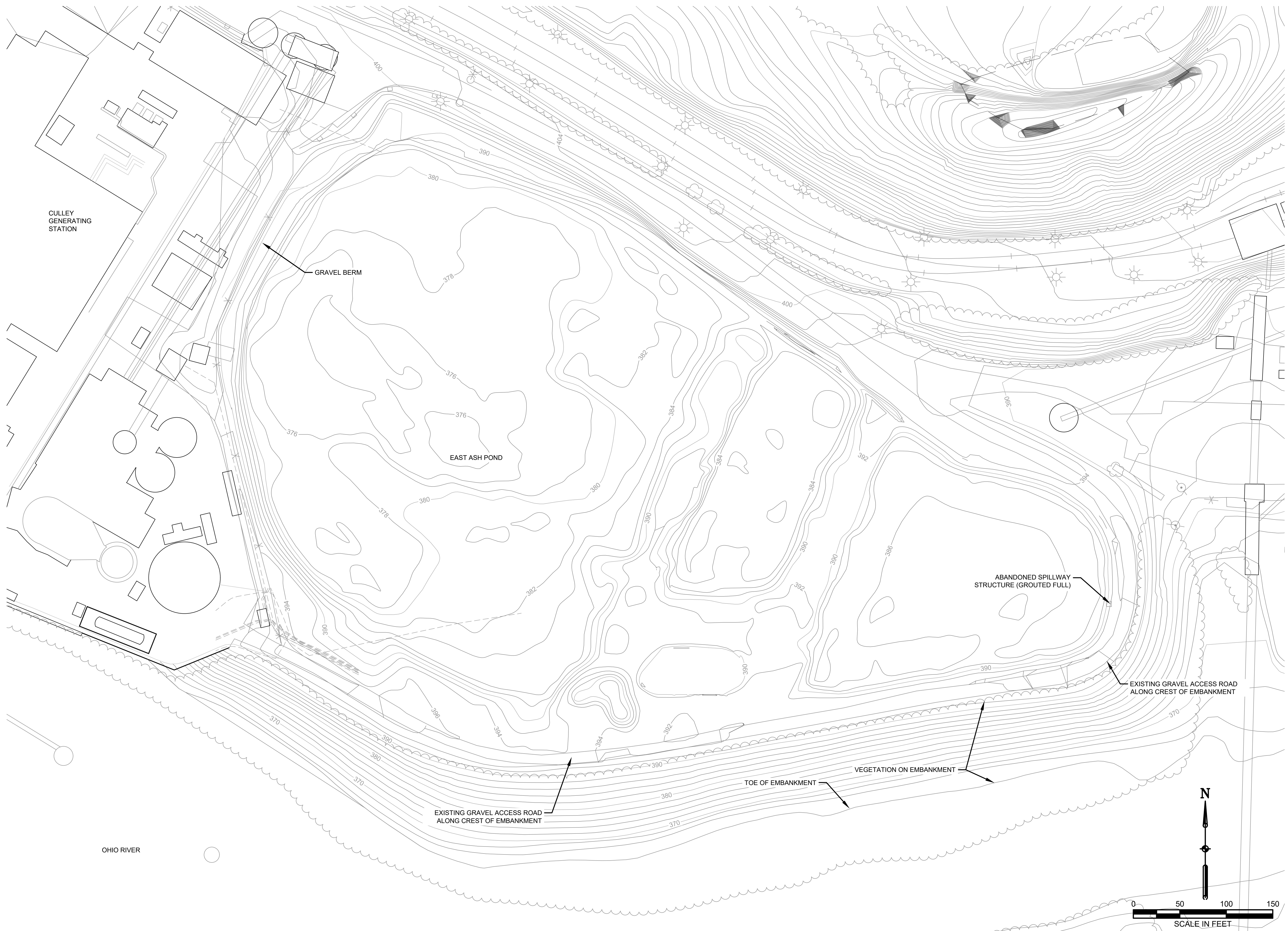

13640 Briarwick Drive
Austin, Texas 78729
1-512-454-4797

About AECOM

AECOM (NYSE: ACM) is a global provider of professional technical and management support services to a broad range of markets, including transportation, facilities, environmental, energy, water and government. With approximately 45,000 employees around the world, AECOM is a leader in all of the key markets that it serves. AECOM provides a blend of global reach, local knowledge, innovation, and collaborative technical excellence in delivering solutions that enhance and sustain the world's built, natural, and social environments. A Fortune 500 company, AECOM serves clients in more than 100 countries and has annual revenue in excess of \$6 billion.